

- NOTES**
- INDICATES STREET LINE HERETOFORE ESTABLISHED AND HEREBY RETAINED.
 - INDICATES STREET LINE HEREBY ESTABLISHED.
 - INDICATES STREET LINE HERETOFORE ESTABLISHED AND HEREBY ELIMINATED.
 - INDICATES ROADWAY AND SIDEWALK TREATMENT HEREBY ESTABLISHED OR HERETOFORE ESTABLISHED AND RETAINED.
 - INDICATES DIMENSION HEREBY ESTABLISHED.
 - INDICATES PARK HERETOFORE ESTABLISHED AND HEREBY RETAINED.
 - INDICATES SIDEWALK AND ROADWAY TREATMENT DIMENSION HEREBY ESTABLISHED.
 - INDICATES DIMENSION HERETOFORE ESTABLISHED AND HEREBY RETAINED.

CP-12670
 CP-14092
 CP-14754
 CP-19057
 App by CAC Oct 3/56 (16)
 App by Bd of E Oct 11/56 (90A)

I, RUTH W. WHALEY, SECRETARY OF THE BOARD OF ESTIMATE OF THE CITY OF NEW YORK DO HEREBY CERTIFY THAT THIS MAP IS OF FIVE SIMILAR MAPS ADOPTED BY THE SAID BOARD OF ESTIMATE ON THE 11TH DAY OF DECEMBER 1956
 DATED: NEW YORK, DECEMBER 1956
Ruth W. Whaley
 SECRETARY BOARD OF EST

CITY OF NEW YORK
 OFFICE OF THE PRESIDENT, BOROUGH OF MANHATTAN
 DEPARTMENT OF BOROUGH WORKS

MAP SHOWING A CHANGE IN THE STREET SYSTEM BY ELIMINATING THE LINES OF
WOOSTER STREET AND GREENE STREET
 FROM WEST HOUSTON STREET TO WEST FOURTH STREET,
 BY WIDENING
WEST BROADWAY
 FROM WEST HOUSTON STREET TO WASHINGTON SQUARE SOUTH
MERCER STREET
 FROM WEST HOUSTON STREET TO WEST FOURTH STREET
 AND
BLEECKER STREET AND WEST THIRD STREET
 FROM WEST BROADWAY TO MERCER STREET
 IN CONNECTION WITH THE SITE FOR
WASHINGTON SQUARE SOUTHEAST AREA

DATED: MAY 21, 1956. SCALE: 1" = 50'
Julius Kahn
 PRESIDENT, BOROUGH OF MANHATTAN
Anthony Donarzo
 CHIEF ENGINEER

DRAWN BY: H. Schurer
 CHECKED BY: F.S.
Edmund D. Kauf
 ENGINEER OF PLANNING
Ernest Smith
 ENGINEER OF DESIGN

ACC. No. 29453

12

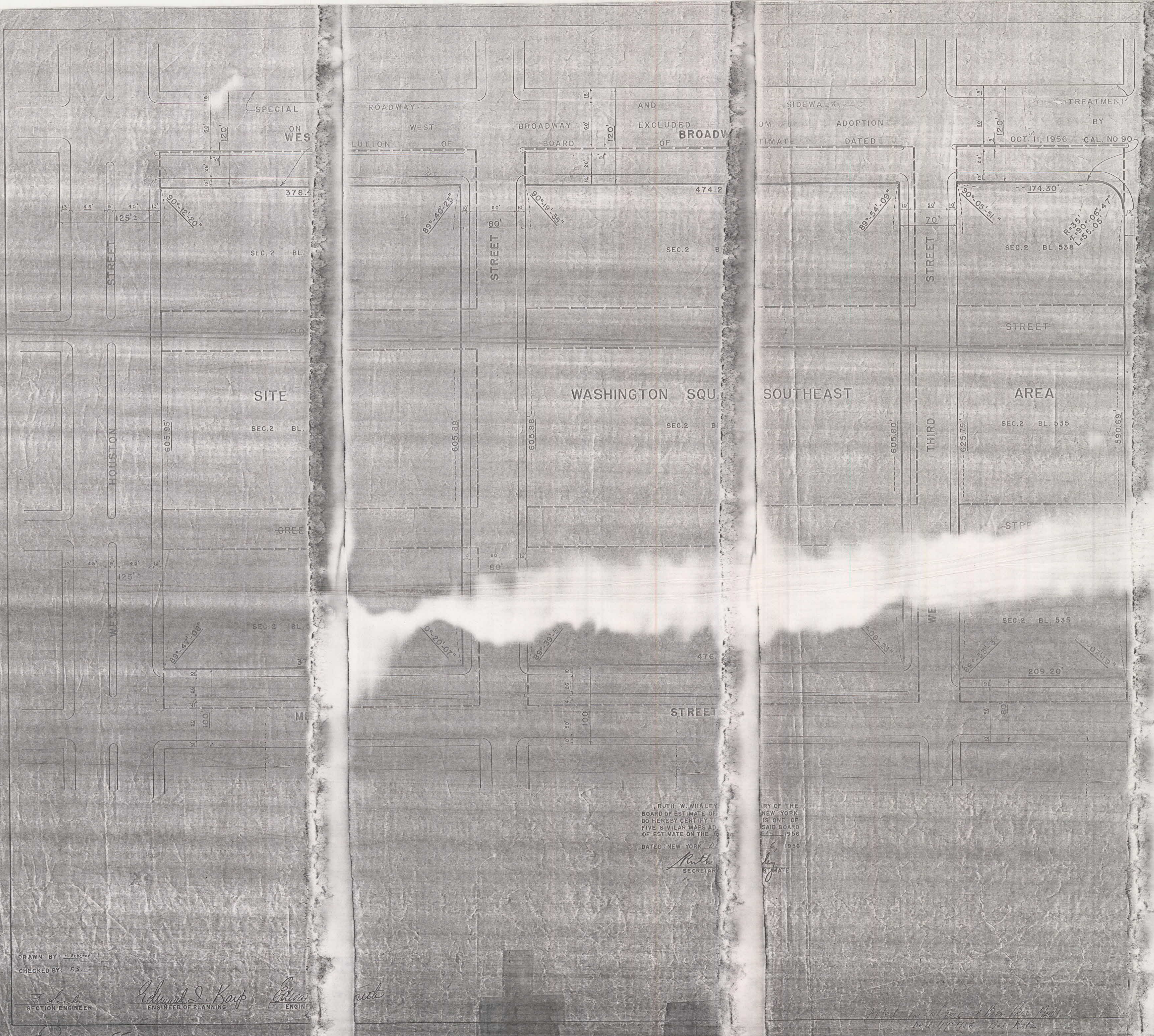

NOTES

- INDICATES STREET LINE HERETOFORE ESTABLISHED AND HEREBY RETAINED.
- INDICATES STREET LINE HEREBY ESTABLISHED.
- INDICATES STREET LINE HERETOFORE ESTABLISHED AND HEREBY ELIMINATED.
- INDICATES ROADWAY AND SIDEWALK TREATMENT HEREBY ESTABLISHED OR HERETOFORE ESTABLISHED AND RETAINED.
- INDICATES DIMENSION HEREBY ESTABLISHED.
- INDICATES PARK HERETOFORE ESTABLISHED AND HEREBY RETAINED.
- INDICATES SIDEWALK AND ROADWAY TREATMENT DIMENSION HEREBY ESTABLISHED.
- INDICATES DIMENSION HERETOFORE ESTABLISHED AND HEREBY RETAINED.

APP. CPC 10/03/56; 16
APP. BOE 10/11/56; 90A
C & F 12/06/56; BP & LOG

SEE CP-12670
 II CP-14092
 II CP-14754
 II CP-19057

CITY OF NEW YORK
 OFFICE OF THE PRESIDENT - BOROUGH OF MANHATTAN
 DEPARTMENT OF BOROUGH WORKS

MAP SHOWING A CHANGE IN THE STREET SYSTEM
 BY ELIMINATING THE LINES OF
WOOSTER STREET AND GREENE STREET
 FROM WEST HOUSTON STREET TO WEST FOURTH STREET,
 BY WIDENING
WEST BROADWAY
 FROM WEST HOUSTON STREET TO WASHINGTON SQUARE SOUTH
MERCER STREET
 FROM WEST HOUSTON STREET TO WEST FOURTH STREET
 AND
BLEECKER STREET AND WEST THIRD STREET
 FROM WEST BROADWAY TO MERCER STREET
 IN CONNECTION WITH THE SITE FOR
WASHINGTON SQUARE SOUTHEAST AREA

DATED: MAY 21, 1956. SCALE: 1" = 50'

Richard J. ...
 PRESIDENT, BOROUGH OF MANHATTAN

Antonio ...
 CHIEF ENGINEER

ACC. No. 29453

DRAWN BY: M. Scherzer
 CHECKED BY: F. S.
Edward D. Kauf
 ENGINEER OF PLANNING
Edna
 ENGINEER

I, RUTH W. WHALEY,
 BOARD OF ESTIMATE OF
 DO HEREBY CERTIFY
 FIVE SIMILAR MAPS AD
 OF ESTIMATE ON THE 16
 DATED: NEW YORK, 11
 6, 1956
Ruth
 SECRETARY

RY OF THE
 NEW YORK
 IS ONE OF
 SAID BOARD
 11, 1956
by
 ESTIMATE

Drawn 55

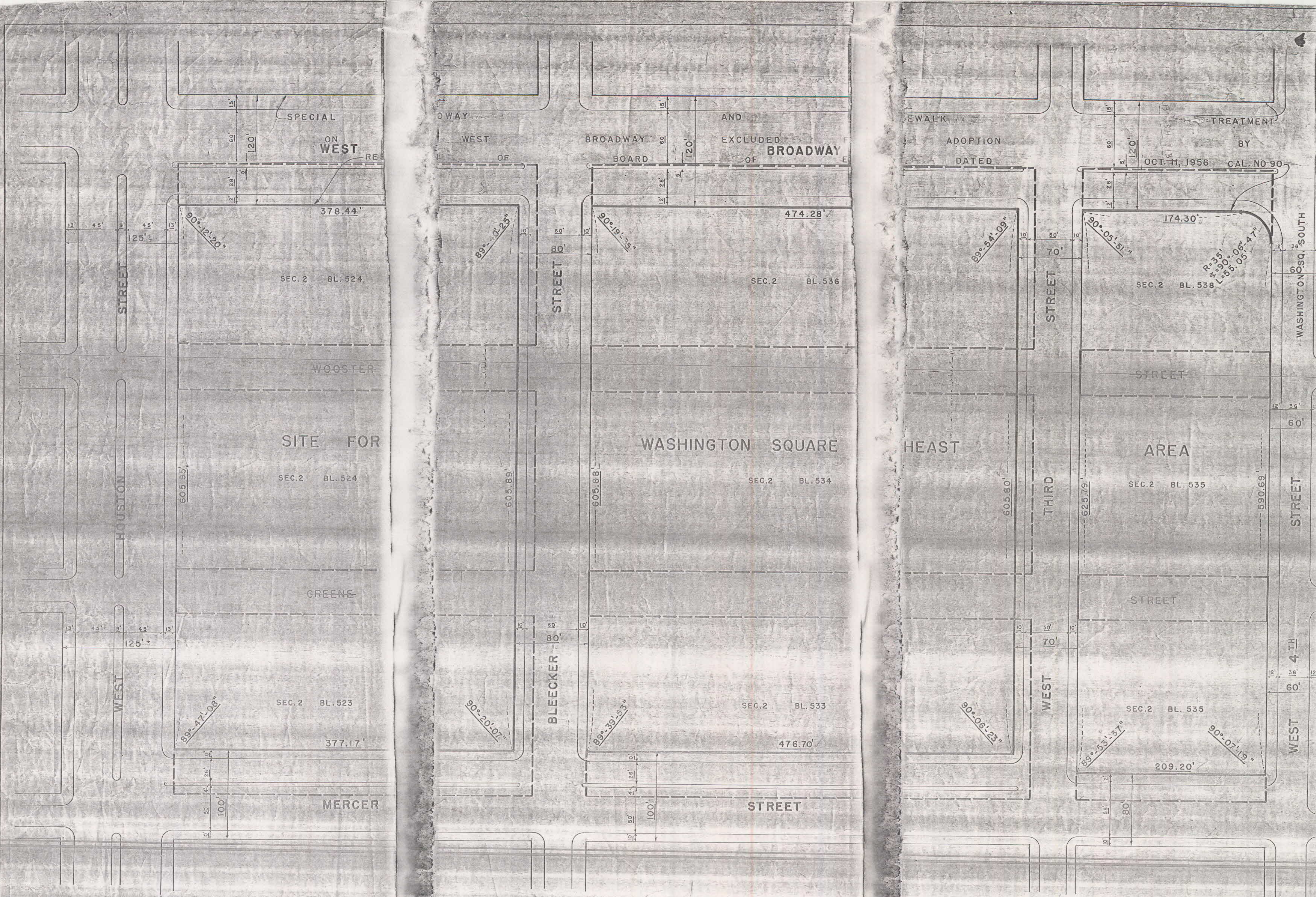

1, RUTH W. WHALEY, SECRETAR
 BOARD OF ESTIMATE OF THE CITY OF
 DO HEREBY CERTIFY THAT THIS MAP IS
 FIVE SIMILAR MAPS ADOPTED BY THE S
 OF ESTIMATE ON THE 11TH DAY OF
 DATED: NEW YORK, DECEMBER
Ruth W. Whaley
 SECRETARY BOARD OF EST

APP. CPC 10/03/56; 16
 APP. BOE 10/11/56; 90A
 C & F 12/06/56; BP & BOE 10G

DRAWN BY: H. Scherer
 CHECKED BY: F.S.
F. Scherer SECTION ENGINEER
Edmund D. Karp ENGINEER OF PLANNING
Edward John ENGINEER OF DESIGN

Drawn 55

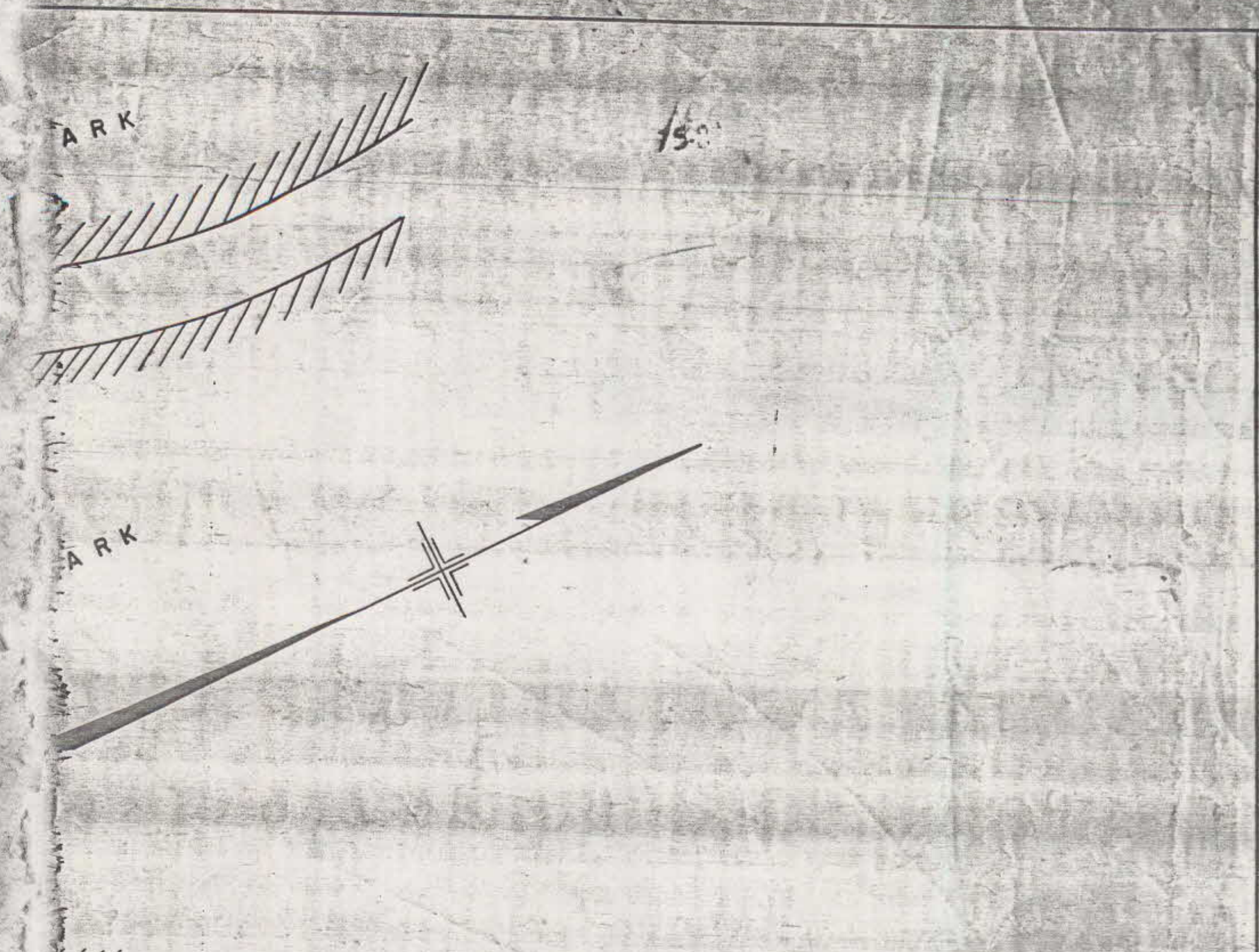

- NOTES**
- INDICATES STREET LINE HERETOFORE ESTABLISHED AND HEREBY RETAINED.
 - INDICATES STREET LINE HEREBY ESTABLISHED.
 - INDICATES STREET LINE HERETOFORE ESTABLISHED AND HEREBY ELIMINATED.
 - INDICATES ROADWAY AND SIDEWALK TREATMENT HEREBY ESTABLISHED OR HERETOFORE ESTABLISHED AND RETAINED.
 - INDICATES DIMENSION HEREBY ESTABLISHED.
 - INDICATES PARK HERETOFORE ESTABLISHED AND HEREBY RETAINED.
 - INDICATES SIDEWALK AND ROADWAY TREATMENT DIMENSION HEREBY ESTABLISHED.
 - INDICATES DIMENSION HERETOFORE ESTABLISHED AND HEREBY RETAINED.

SEE CP-12670
 " CP-14092
 " CP-14754
 " CP-19057

CITY OF NEW YORK
 OFFICE OF THE PRESIDENT, BOROUGH OF MANHATTAN
 DEPARTMENT OF BOROUGH WORKS

MAP SHOWING A CHANGE IN THE STREET SYSTEM
 BY ELIMINATING THE LINES OF
WOOSTER STREET AND GREENE STREET
 FROM WEST HOUSTON STREET TO WEST FOURTH STREET,
 BY WIDENING
WEST BROADWAY
 FROM WEST HOUSTON STREET TO WASHINGTON SQUARE SOUTH,
MERCER STREET
 FROM WEST HOUSTON STREET TO WEST FOURTH STREET
 AND
BLEECKER STREET AND WEST THIRD STREET
 FROM WEST BROADWAY TO MERCER STREET
 IN CONNECTION WITH THE SITE FOR
WASHINGTON SQUARE SOUTHEAST AREA

DATED: MAY 21, 1956. SCALE: 1" = 50'

Anthony J. ...
 PRESIDENT, BOROUGH OF MANHATTAN

Anthony J. ...
 CHIEF ENGINEER

ACC. No. 29453